

Organised by:



Premier Sponsor:



Media Sponsors:



Partner:



Sponsors:



VECTORWORKS
A NEMETSCHEK COMPANY

The UK's premier Rail Property Event since 2000

Rail Stations and Property Summit

Unlocking Housing, Land Value
and Future Opportunities

Wednesday 21 February 2018

15 Hatfields, London



- Using railway property to unlock significant residential development
- Explore new models for collaborative delivery
- Examine the barriers to successful high intensity development around rail hubs
- Designing stations for future challenges and current needs

www.stationsandproperty.co.uk

Rail Stations and Property Summit

Unlocking Housing, Land Value and Future Opportunities

With a growing population and economy, demand for both rail travel and housing is at historic highs and continues to rise.

The Government and authorities want more new homes to be built on railway land to tackle the housing shortage, swelling the ranks of commuters as the rail industry seeks extra capacity at stations and to unlock land value to fund infrastructure investment.

Can local authorities, the property sector and the railways work together in the face of these challenges and make new housing around rail stations work?

The **Rail Stations and Property Summit 2018** is being convened to find the answers.

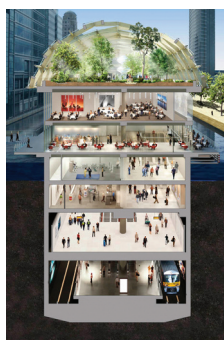

Why attend?

Relationships

Rail Stations and Property is the leading event that unites two professional worlds.

This event identifies partnership opportunities to enable relationships between a range of organisations from Network Rail to developers, from train operators to consultants and from landowners to politicians.

Extend your professional network and gain exposure to emerging opportunities.

Insight, expertise and best practice

You'll hear from the leaders of some of the largest investment projects of our time and from local authorities and other public bodies that are putting rail stations at the heart of redevelopment and development strategies which are reshaping our cities and towns.

Collaboration and cross-disciplinary working

Delivery models are the heartbeat of successful development, from a small station enhancement to major infrastructure projects for national and international importance. Hear the experiences of those who have made cross-disciplinary and multi-agency collaboration work and the lessons learnt along the way.



Nigel Harris
Managing Director,
The Railway Consultancy



Angela Barnicle
Head of Asset Management,
Leeds City Council



Bridget Rosewell
Commissioner, National
Infrastructure Commission



Paul Beatty-Pownall
Partner, bpr architects



Alan Nettleton
Senior Technologist,
Transport Systems Catapult



Phillip Beer
Partner, Burges Salmon

21 February 2018 Programme

09.10 Registration
Tea and coffee served in the exhibition area

09.40 **Introduction and Welcome from the Plenary Chair**
Phillip Beer, Partner, Burges Salmon

Plenary: Policy, property and stations

10.00 **All change for Network Rail's Property Portfolio**
Kevin McGinley, Property Project Lead, Network Rail

10.15 **The past is not necessarily a guide to the future – In-depth look at the figures and trends**
Nigel Harris, Managing Director, The Railway Consultancy

10.30 **Infrastructure and Partnerships**
Bridget Rosewell, Commissioner, National Infrastructure Commission

10.45 Questions and Discussion

11.00 *Morning tea and coffee served in the exhibition area*

Supporting Regeneration and Housing

11.20 **Regeneration stations to deliver housing**
Sir Edward Lister, Chairman, Homes England (formerly HCA)

11.35 **Out of thin air – overbuilding above railway lines**
John Parker, Director, WSP

11.45 **Evaluating station designs and scenarios – Lea Bridge case study**
Paul Beaty-Pownall, Partner, bpr architects

11.55 **Leeds integrated station masterplan HS2 Hub**
Angela Barnicle, Head of Asset Management, Leeds City Council

12.05 Panel Discussion

12.30 *Networking Lunch served in the exhibition area*

Unlocking land value and funding: Frameworks, vehicles and mechanisms

13.45 **Unlocking complex sites, public sector ownership and HS2 Growth Partnership sites**
Jamie Kerr, Director, HS2 Growth Partnership

14.00 **SLC AECOM - Rail Advisory Framework**
Ian Baxter, Rail Strategy Expert, SLC and Russell Jackson, Head of Rail, AECOM UK & Europe

14.15 **The Hub, Solihull, Urban Growth Company**
Huw Lewis, Managing Director, Urban Growth Company

14.30 **Funding infrastructure through capturing increases in future land value**
East West Railway Company (invited)

14.45 Questions and Discussion

15.00 *Afternoon tea and coffee served in the exhibition*

The Disruptors are Coming

15.15 Panel and Discussion including:

Changing Journey Patterns: First/Last mile of Journeys

Kieran Harte, Head of Cities, Uber Midlands & South West UK, Scotland, Wales, Ireland, NI, Uber

Predicting the future of cities - exploring the impacts of different design, policy, management and investment scenarios on an integrated data platform

Peter Ferguson, CEO, Prospective

CAV's, parking and land use at stations

Alan Nettleton, Senior Technologist, Transport Systems Catapult

Pushing development potential boundaries using travel planning

Jon Harris, technical Director, Integrated Transport Planning

16.00 Close



Huw Lewis
Managing Director,
Urban Growth Company



Kieran Harte
Head of Cities, Uber
Midlands & South West UK,
Scotland, Wales, Ireland, NI



Jamie Kerr
Director, HS2 Growth
Partnership



Sir Edward Lister
Chairman, Homes England



John Parker
Director, WSP



Peter Ferguson
CEO, Prospective

Delegate rates

Delegate rates

First delegate **£345 + VAT**

Each additional delegate **£175 + VAT**

First Local Authority delegate **Free***

Secure your place online at:

TransportXtra.com/shop/events

* 1 Per Authority, these sponsor-supported places are limited to first come first served, please contact conferences@landor.co.uk for details.

Enquiries

Email: conferences@landor.co.uk
or call **Riannah** on: **020 7091 7865**

Sponsorship & Exhibition opportunities

Call: **Rod Fletcher** on: **0191 280 1410**
or email: rod.fletcher@landor.co.uk

Who you will meet

- Developers
- Rail companies
- Government & regulatory bodies
- Property companies and retailers
- Fund managers and banks
- Property agents
- Local authorities
- Regeneration agencies
- Consultants
- Lawyers and other professionals

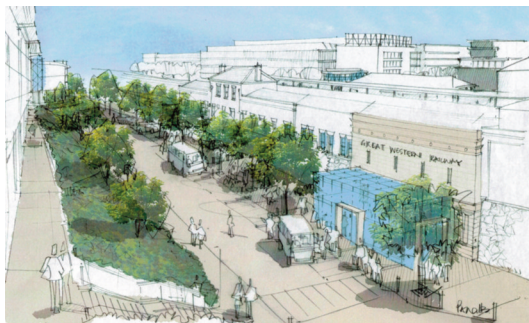

Rail Stations and Property Summit: Responding to the challenges of increasing passenger numbers and accommodating population growth

Landor LINKS connects with every local authority in the UK, central government, universities and research bodies, suppliers, consultants and service providers.

Professionals depend on us for authoritative information, news and analysis. We deliver to professional networks through targeted events, traditional print, such as the respected transport planning and policy journal *Local Transport Today*, online and social media.

www.stationsandproperty.co.uk